

CARACTERÍSTICAS / FEATURES

Material hormigón Petra1
Acabado decapado e hidrofugado
Dimensiones l. 120, a. 120, h. 8 cm
Color ver carta de colores
Fijación simplemente apoyado
Peso / Capacidad 238 Kg
Palet 120 x 80 x 80 cm [6u]
Peso bruto 1450 Kg

Material precast concrete Petra1
Finish scaled & waterproofed
Dimensions l. 120, w. 120, h. 8 cm
Colour see colour catalogue
Fixing resting on the ground
Weight / Capacity 238 Kg
Package 120 x 80 x 80 cm [6u]
Weight package 1450 Kg

diseñador / design: Ernest Perera

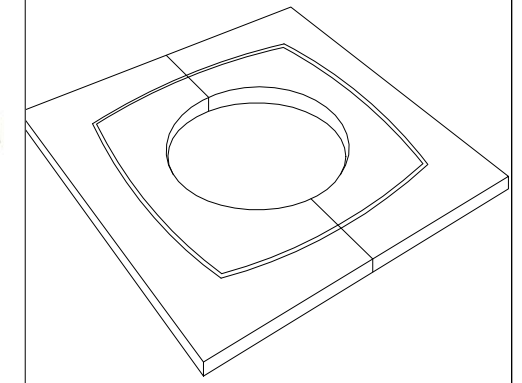

TV 120

Tàrraga, Lleida - Tel. +34 973 15 87 03 - www.magourban.com - info@magourban.com

magourban

GEOMETRIA / GEOMETRY

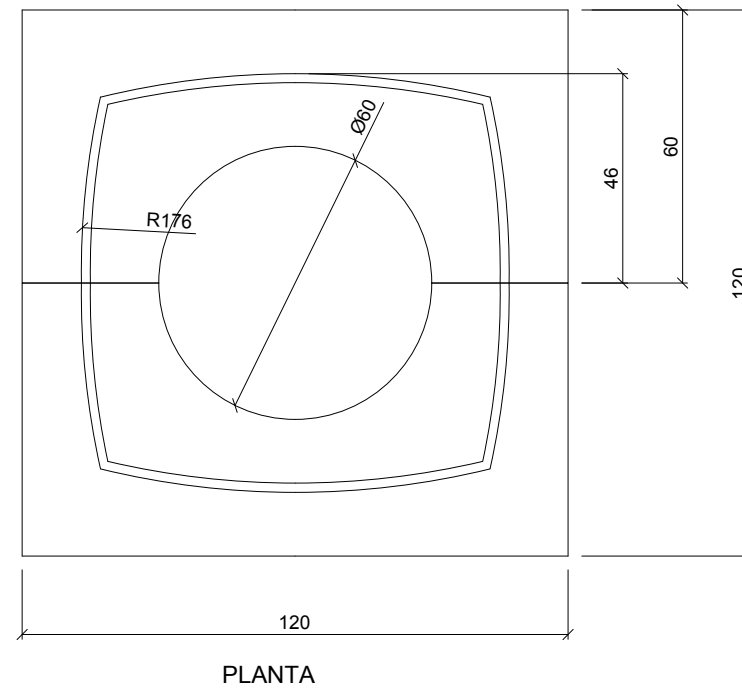

MANIPULACIÓN E INSTALACIÓN / HANDLING AND INSTALLATION

elevación / hoisting
 P= 120 Kg

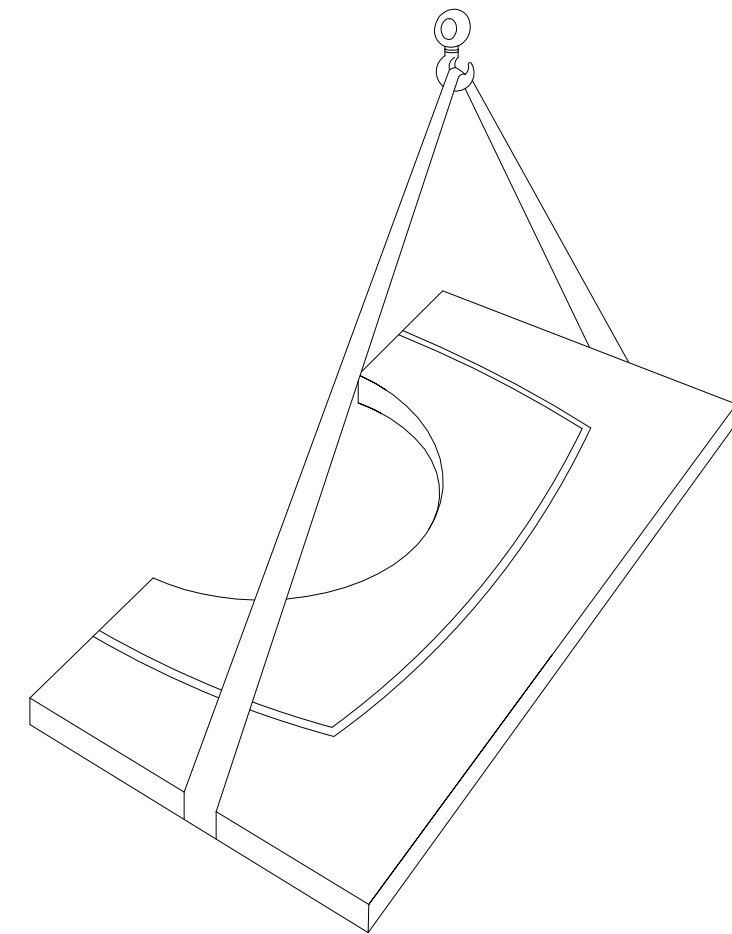

ESPECIFICACIONES / SPECIFICATIONS



SECTION

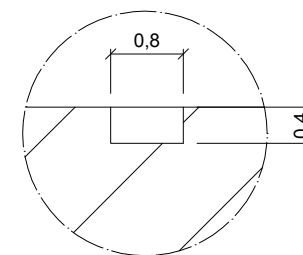

DETAIL