

**CARACTERÍSTICAS / FEATURES**

**Material** hormigón petra 1  
**Acabado** decapado e hidrofugado  
**Dimensiones** l. 175, a. 152, h. 35 cm.  
**Color** ver carta de colores  
**Fijación** simplemente apoyado  
**Peso / Capacidad** 219 Kg / 520 L

**Material** concrete petra 1  
**Finish** scaled and waterproofed  
**Dimensions** l. 175, w. 152, h. 35 cm  
**Colour** see colour catalogue  
**Fixing** resting on the ground  
**Weight / Capacity** 219 Kg / 520 L

diseñador / design: I+D mago:urban

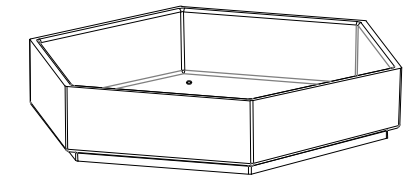

**GEOMETRIA / GEOMETRY**

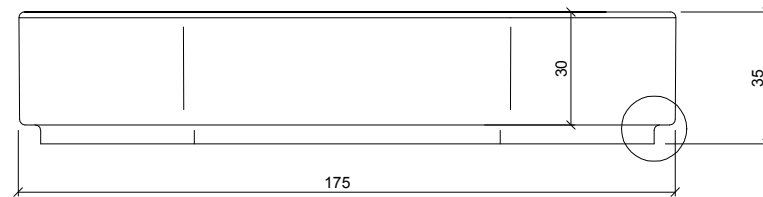

ALZADO / FRONT VIEW

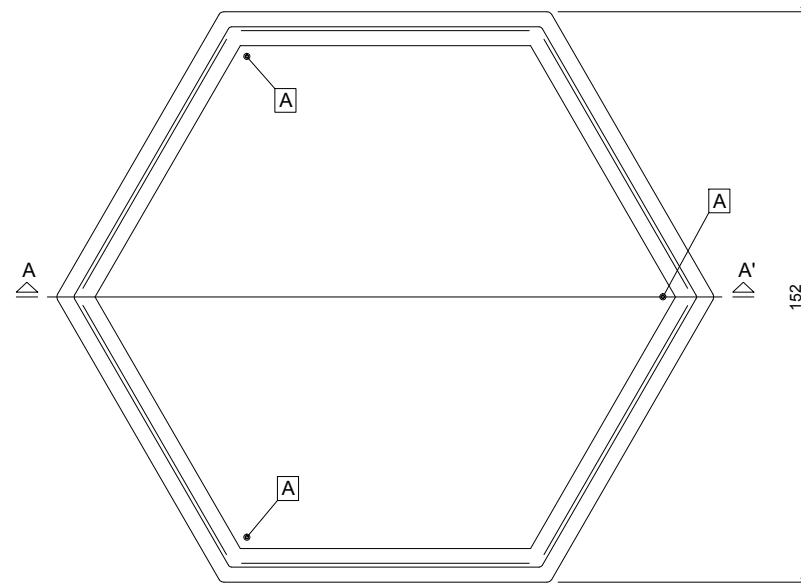

PLANTA / TOP VIEW

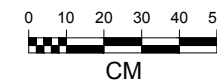

**MANIPULACIÓN E INSTALACIÓN / HANDLING AND INSTALLATION**

1 enroscar cáncamo, fijar eslingas e instalar / thread the eyebolt, fixing slings and install.

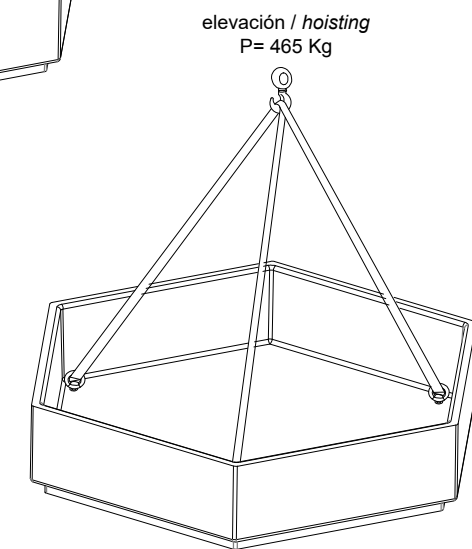
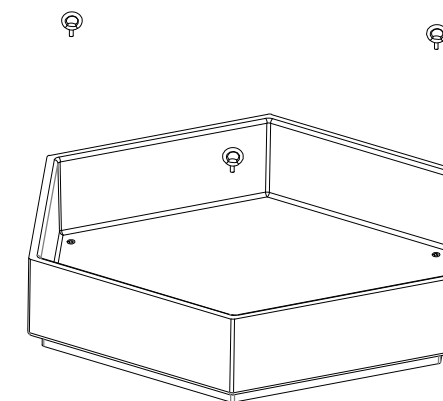

**ESPECIFICACIONES / SPECIFICATIONS**

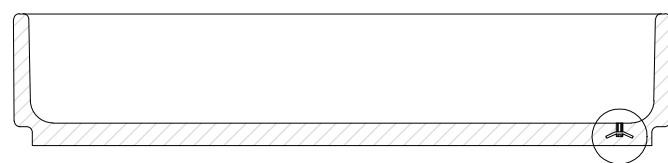

SECCIÓN A-A' / SECTION A-A'

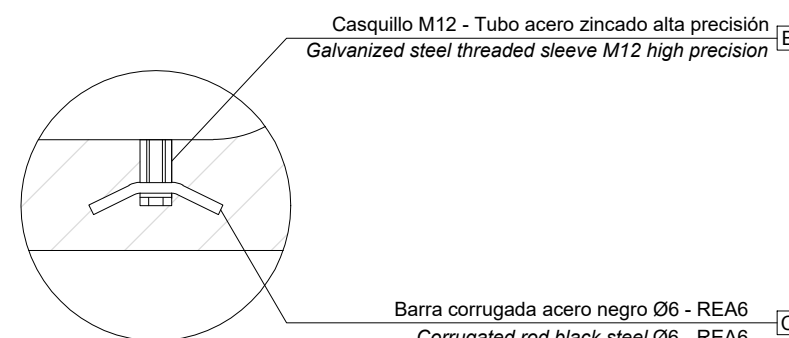

DETALLE D / DETAIL D

- A cáncamo / eyebolt
- B casquillo roscado / thread sleeve
- C barra corrugada / corrugated rod

