

**CARACTERÍSTICAS / FEATURES**

**Material** hormigón petra 1  
**Acabado** decapado e hidrofugado  
**Dimensiones** l. 170, a. 163, h. 45 cm.  
**Color** ver carta de colores  
**Fijación** simplemente apoyado o mediante resina epoxy  
**Peso** 1930 Kg  
**Bulto** 180 x 180 x 65 cm  
**Peso bulto** 1970 Kg

**Material** precast concrete petra 1  
**Finish** scaled and waterproofed  
**Dimensions** l. 170, w. 163, h. 45 cm  
**Colour** see colour catalogue  
**Fixing** resting on the ground or with epoxy resin  
**Weight** 1930 Kg  
**Package** 180 x 180 x 65 cm  
**Weight package** 1970 Kg

diseñador / design: La Noche de la Iguana - Kiko Solsona

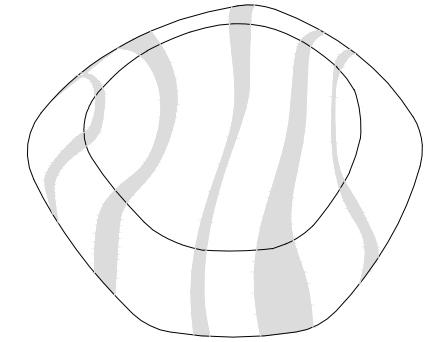
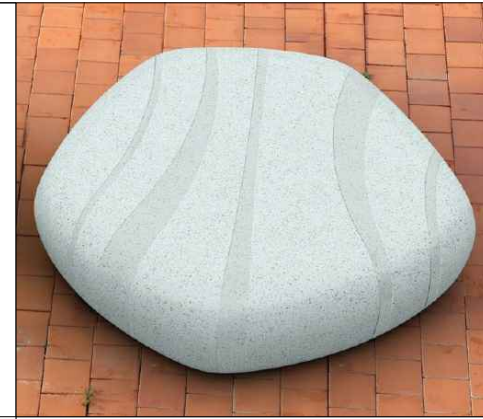

**GEOMETRIA / GEOMETRY**

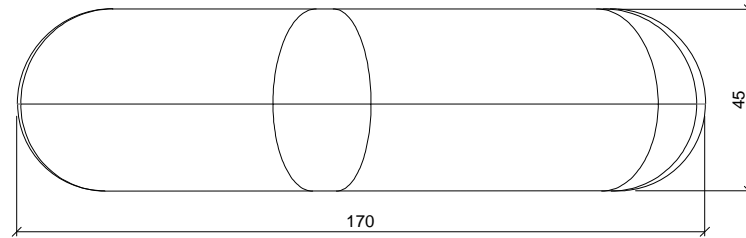

ALZADO / FRONT VIEW

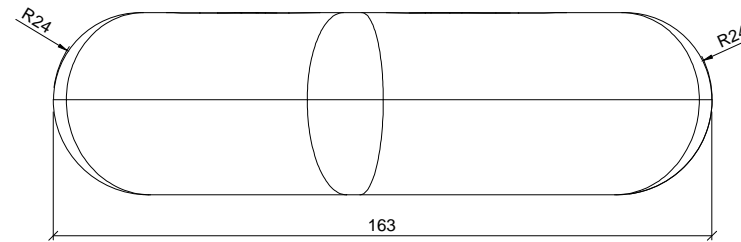

PERFIL / PROFIL VIEW

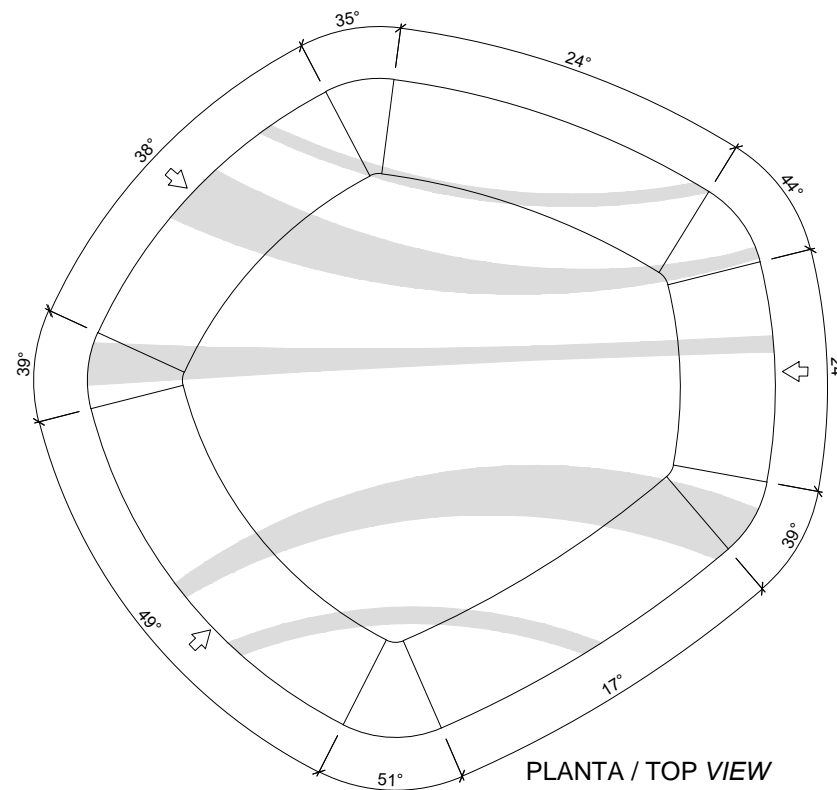

PLANTA / TOP VIEW

↑ ubicación del casquillo roscado  
 location of steel socket threaded

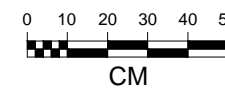

**MANIPULACIÓN E INSTALACIÓN / HANDLING AND INSTALLATION**

elevación / hoisting  
 P= 1260 Kg

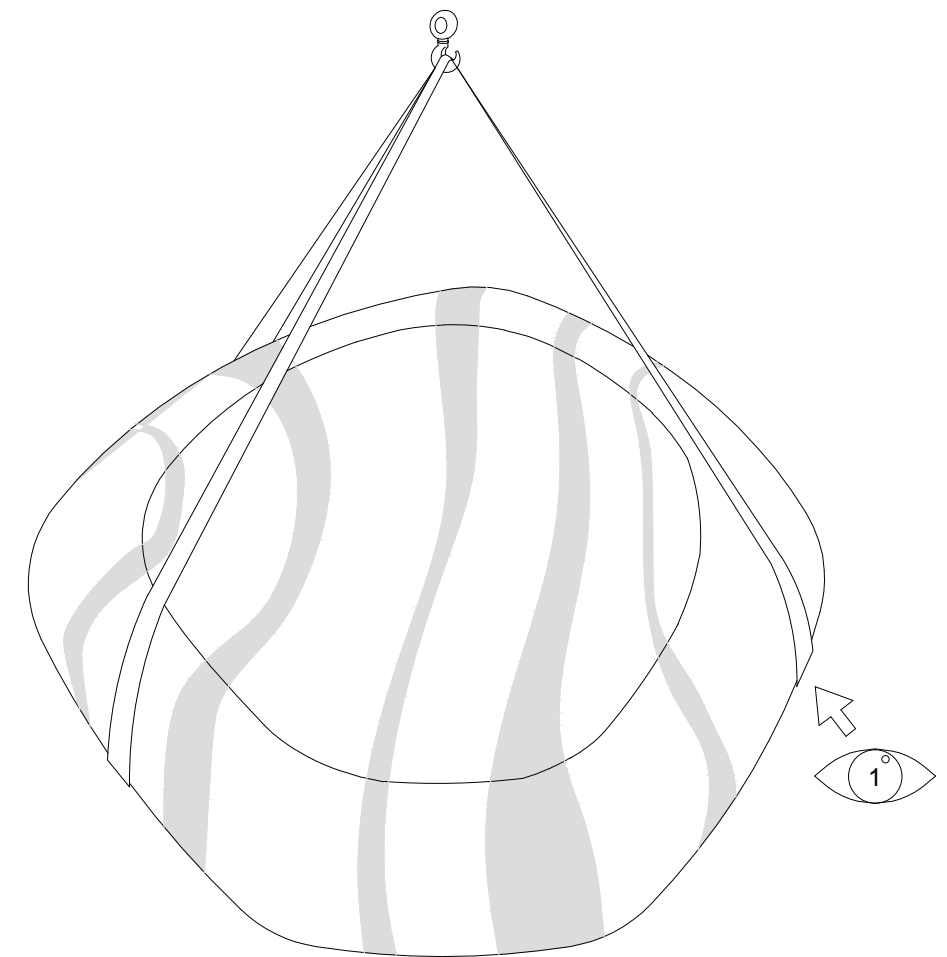

**ESPECIFICACIONES / SPECIFICATIONS**

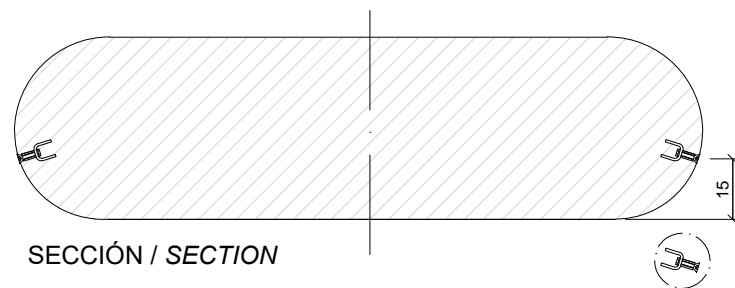

SECCIÓN / SECTION

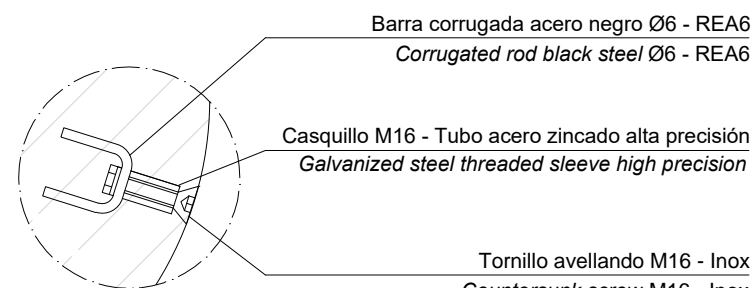

DETALLE / DETAIL

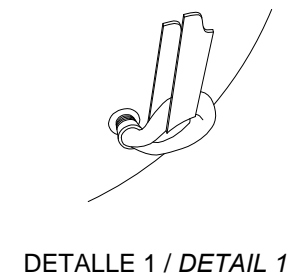
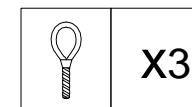

DETALLE 1 / DETAIL 1

**Material** hormigón petra 1  
**Acabado** decapado e hidrofugado  
**Dimensiones** l. 170, a. 163, h. 45 cm.  
**Color** ver carta de colores  
**Fijación** simplemente apoyado o mediante resina epoxy  
**Peso** 1260 Kg  
**Bulto** 180 x 180 x 65 cm  
**Peso bulto** 1300 Kg

**Material** precast concrete petra 1  
**Finish** scaled and waterproofed  
**Dimensions** l. 170, w. 163, h. 45 cm  
**Colour** see colour catalogue  
**Fixing** resting on the ground or with epoxy resin  
**Weight** 1260 Kg  
**Package** 180 x 180 x 65 cm  
**Weight package** 1300 Kg

diseñador / design: La Noche de la Iguana - Kiko Solsona

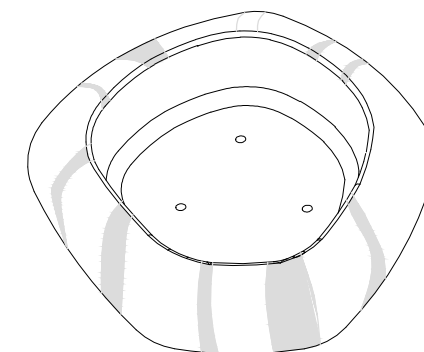

**GEOMETRIA / GEOMETRY**

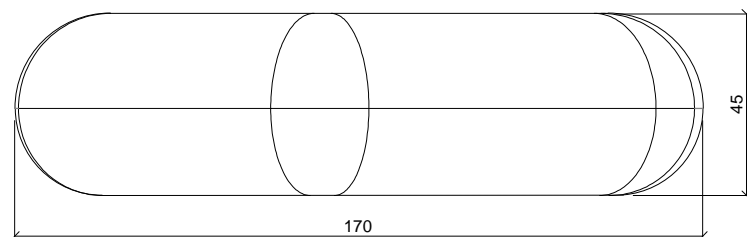

ALZADO / FRONT VIEW

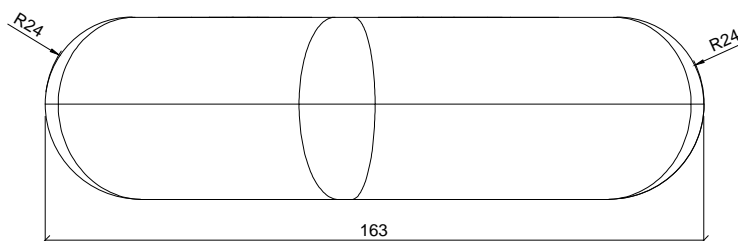

PERFIL / PROFIL VIEW

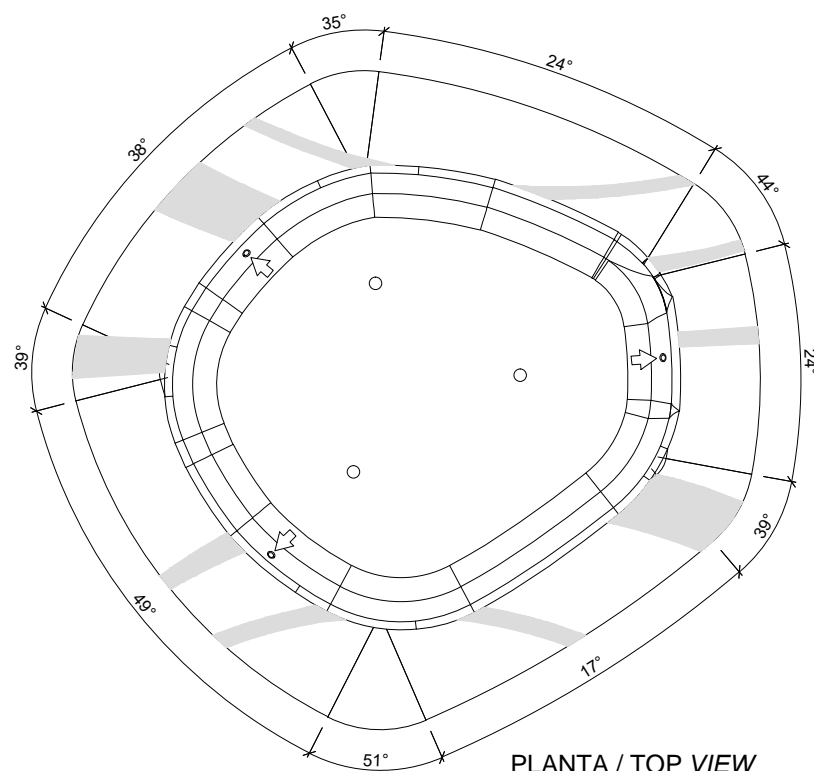

PLANTA / TOP VIEW

↑ ubicación del casquillo roscado  
 location of steel socket threaded

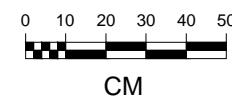

**ESPECIFICACIONES / SPECIFICATIONS**

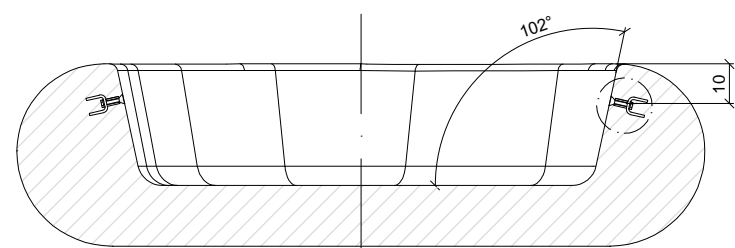

SECCIÓN / SECTION

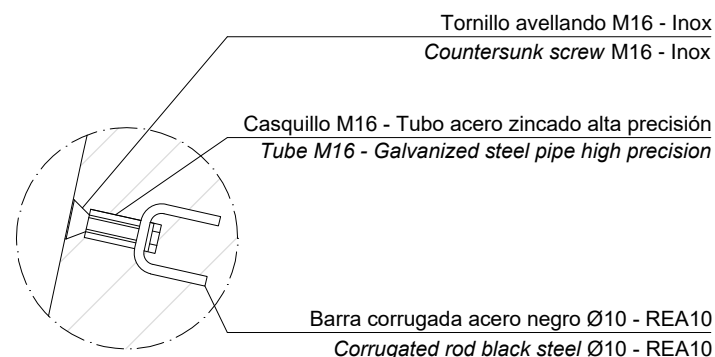

DETALLE / DETAIL

Tornillo avellando M16 - Inox  
 Countersunk screw M16 - Inox

Casquillo M16 - Tubo acero zincado alta precisión  
 Tube M16 - Galvanized steel pipe high precision

Barra corrugada acero negro Ø10 - REA10  
 Corrugated rod black steel Ø10 - REA10

**MANIPULACIÓN E INSTALACIÓN / HANDLING AND INSTALLATION**

elevación / hoisting  
 P= 1260 Kg

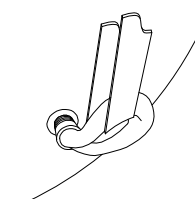
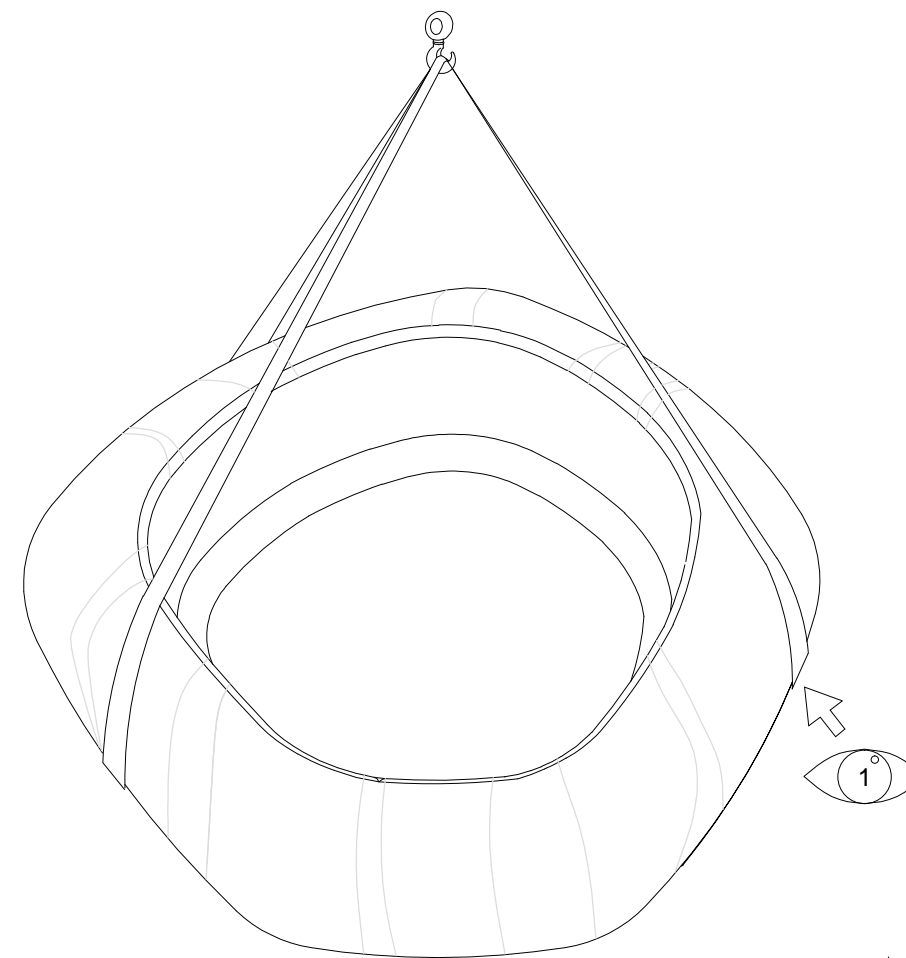

DETALLE 1 / DETAIL 1

